

## PRINTABLE INFO SHEET

Series: Blazer Elite

Model: TD1304-P Blazer Elite



## About This Model

Style: Ranch / Bedrooms: 2 / Bathrooms: 2 / Square Feet: 1253

## CUSTOMER CONTACT

Notes:

---

---

---

---

# PRINTABLE INFO SHEET

Series: Blazer Elite

Model: TD1304-P Blazer Elite



## Floorplan

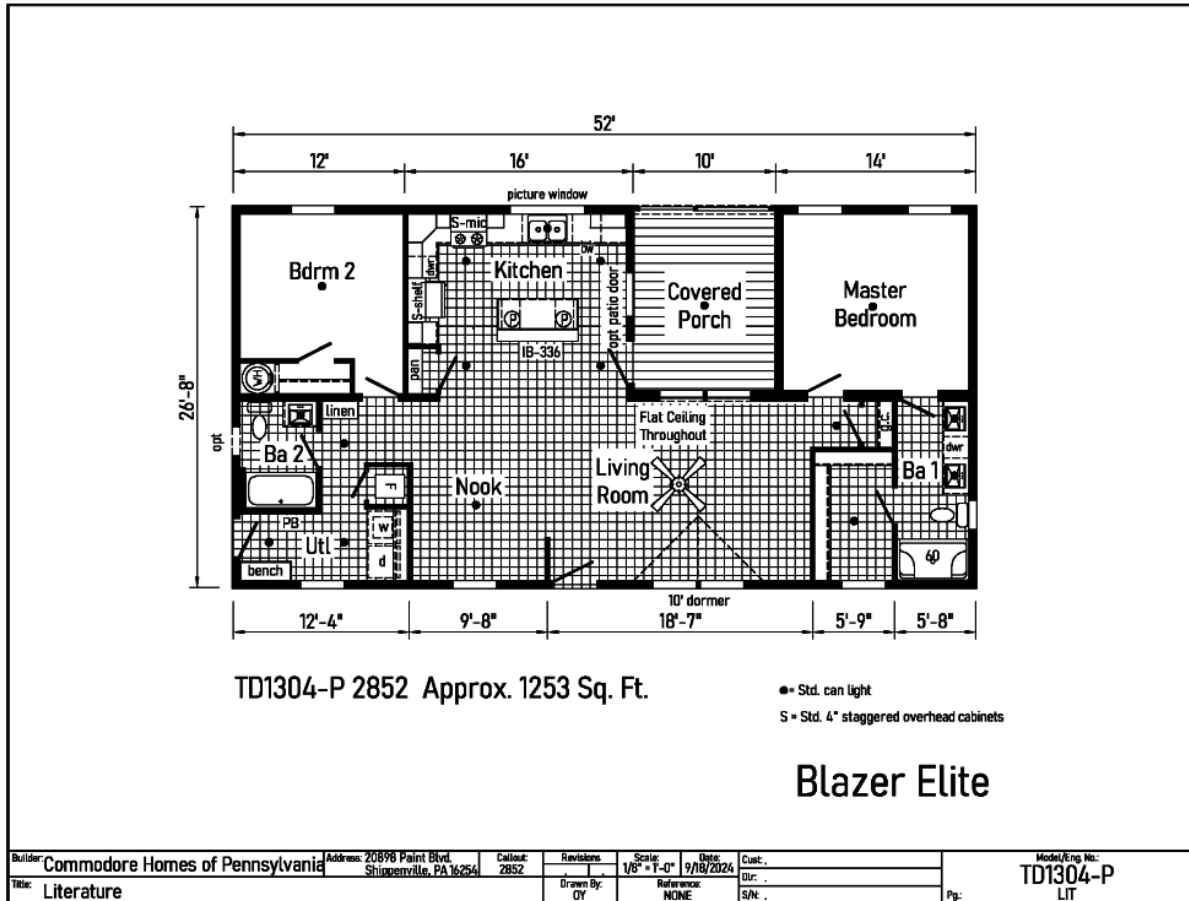

## CUSTOMER CONTACT

Notes:

---



---



---



---

# PRINTABLE INFO SHEET

**Series: Blazer Elite**

**Model: TD1304-P Blazer Elite**



## Standards & Features

### Interior

- Flat Ceiling Throughout
- Stipple Ceiling
- 8' Sidewall Height
- Take Away Carpet
- Rebond Carpet Pad
- Tackstrip Carpet Installation
- Shaw Vinyl Flooring
- Vinyl Flooring Entry Foyer
- Vinyl Wall Coverings on Gypsum
- Pre-Hung White 2-Panel Interior Doors with 2 Mortised Hinges
- 30" Interior Passage Doors
- Metal Interior Passage Sets
- Floor Mount Door Stops
- Smoke Detectors with Battery Back-Up
- Wire Shelving in Closets & Above W/D
- Designer-Coordinated Window Treatments
- LED Lights Throughout
- Ceiling Fan in Living Room

### Kitchen

- KCMA Certified Cabinets
- Mission Cabinet Doors
- Concealed Cabinet Hinges
- Brushed Nickel Cabinet Hardware
- 30" Staggered Overhead Cabinets
- Lined Base & Overhead Cabinets
- Kitchen Island
- Soft Close Undermount Drawer Guides

### Kitchen (continued)

- Base Shelves in Cabinets
- Laminate Countertops
- 4" Laminate Backsplash
- Stainless Steel Sink - 33x22x8
- Hi-Rise Structured Flow Brushed Nickel Kitchen Faucet
- (2) Pendant Lights over Island

### Appliances

- 20 CuFt, Stainless Steel Refrigerator w/Top Freezer
- 30" Stainless Steel Deluxe Electric Range
- Stainless Steel Dishwasher 4 Cycle
- Stainless Steel Over the Range Microwave

### Baths

- 60" Fiberglass Shower - Master Bath
- 60" One Piece Fiberglass Tub/Shower - Bath 2
- 1.6 Gallon Per Flush Elongated Toilets
- Laminate Countertops
- 4" Laminate Backsplash
- Lighted Vent Fan in Each Bath
- Mission Cabinet Doors
- Concealed Cabinet Hinges
- Brushed Nickel Cabinet Hardware
- Base Shelf in Vanities
- 36" High Vanities
- Square China Lavs
- Double Lav Sinks - Master Bath
- Structured Flow Brushed Nickel Faucets

### Bedrooms

- LED Lights

## CUSTOMER CONTACT

Notes:

---

---

---

---



# PRINTABLE INFO SHEET

**Series: Blazer Elite**

**Model: TD1304-P Blazer Elite**



## Standards & Features (continued)

### Bedrooms (continued)

Egress Window Each Bedroom  
Wire Shelving in Wardrobes  
Recessed 6" LED Light  
in All Walk-In Closets & Pantry

### Utilities

Plumbed & Wired for Washer  
with Quarter Turn Valve  
Vented and Wired for Dryer  
200 AMP Electrical Service  
Copper Wiring Throughout  
30 Gallon Electric Water Heater  
with Pan  
Water Shut Off Throughout  
Main Water Shut off in Utility  
Electric Furnace w/ Grilled Door  
Air Exchange System for Furnace  
Aluminum Heat Ducts  
In-Floor Cross-Over Heating System  
Air Conditioner Ready Thermostat  
w/ 5-Wires

### Exterior

Gatsby Light at Front Door  
Seeded Glass Light at Rear Door  
GFI-Protected Exterior Receptacle  
(1) Exterior Water Faucet  
Vinyl Dutch Lap Siding  
Sheathing Board Under Siding  
Shingle Roof with  
4" Eaves on Single Section Homes  
10" Eaves on Ranch Homes

### Exterior (continued)

Ridgevent Roof Ventilation System  
6-Panel Fiberglass Front Door 38x80  
1-Lite Rear Door 34x80  
12" Raised Panel Shutters on  
Front Door Side

### Construction

Transverse Floor System  
2x6 - 14' & 28' Wide  
2x8 - 16' & 32' Wide  
2x6 Exterior Walls on 16" Centers\*\*  
20# Roof Load  
3/4" OSB T and G Floor Decking  
Recessed Frame  
2 Adjustable Outriggers

### Energy Efficient Standards

Vinyl Insulated Low-E Windows  
R-22 Fiberglass in Floor  
R-19 Fiberglass in Walls  
R-25 Avg. Blown in Ceiling-Single  
R-28 Avg. Blown in Ceiling-Multi

## CUSTOMER CONTACT

Notes:

---

---

---

---